

Issue	Date	Description	Initial
ISSUE A	02-06-08	CONCEPTUAL FLOOR PLAN	M.D.P.
ISSUE B	05-07-08	AMENDED CONCEPTUAL FLOOR PLAN	M.D.P.
ISSUE C	10-10-08	TENDER DRAWINGS	M.D.P.

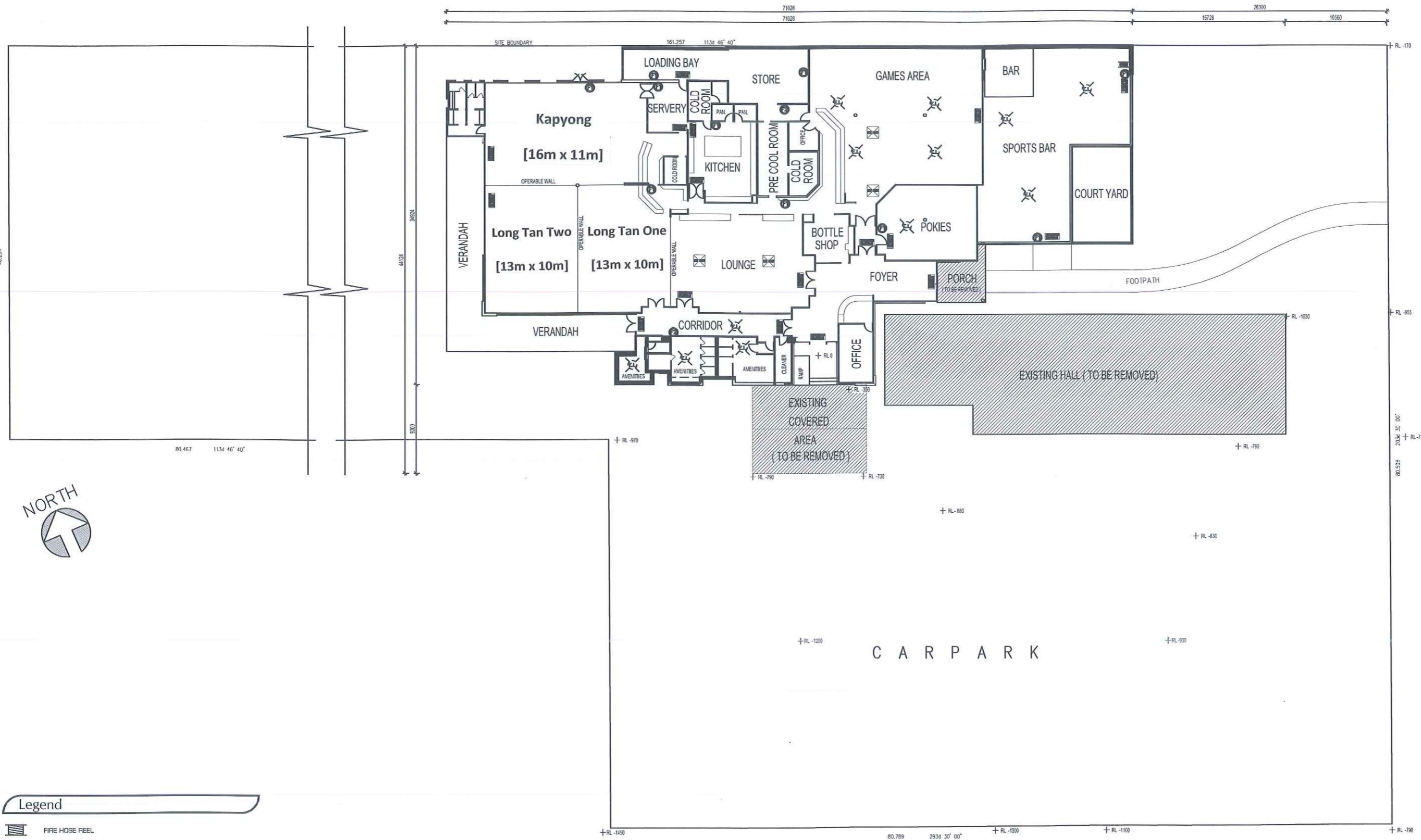

Legend

- FIRE HOSE REEL
- ILLUMINATED 'EXIT' SIGN
- 4.5kg DRY POWDER EXTINGUISHER
- 9.0l WATER EXTINGUISHER
- EMERGENCY LIGHTING TO AS/NZS 2293.1
NUMBER REQUIRED DEPENDENT ON THE LUMINANCE OF LIGHT FIXTURE. INDICATION OF AREA REQUIRING LIGHTING.

Existing Site Plan
SCALE 1 : 200

Floor Area
EXISTING AREA TO REMAIN = 2112 Sq.m.

Property Description
SUB 2 ON RP 52621
LOT 1 ON RP 108313
LOT 2 ON RP 152836 &
LOT 4 ON RP 178673
PARISH OF CHINCHILLA
COUNTY OF LYTTON

CONCEPTUAL DESIGN ONLY
Not to be used for quotation
or construction purposes

Client
CHINCHILLA RSL

Project
PROPOSED EXTENSIONS
61 HEENEY STREET
CHINCHILLA QLD 4413

Scale 1 : 200 @A1
Date 2ND JUNE 2008
Drawn M.D. PEARCE
Sheet 1 OF 7

Job No. D227-08
Issue C



Approved
Designed
M.D. PEARCE



Licensed Building Designers
A.G. Martin Pty. Ltd.
QBSA Lic. No. 1077723
Licensed Under QBSA Act 1991
www.martindesign.com.au

42 North Street,
DALBY QLD 4405
Ph: (07) 4662 1403
Fax: (07) 4669 8049

A.G. MARTIN
DESIGN & DRAFTING